

# Stanley Park Mall

1005 Ottawa Street North, Kitchener ON





# About the Location

Stanley Park Mall is located on the bustling east side of Kitchener. Surrounded by the densely populated and diverse community of Stanley Park, this centre offers a great tenant mix including Zehrs and Shoppers Drug Mart, making it an ideal destination for one-stop shopping. Additionally, this enclosed retail hub is situated next to several Grand River Transit bus stops, making it easily accessible for all.

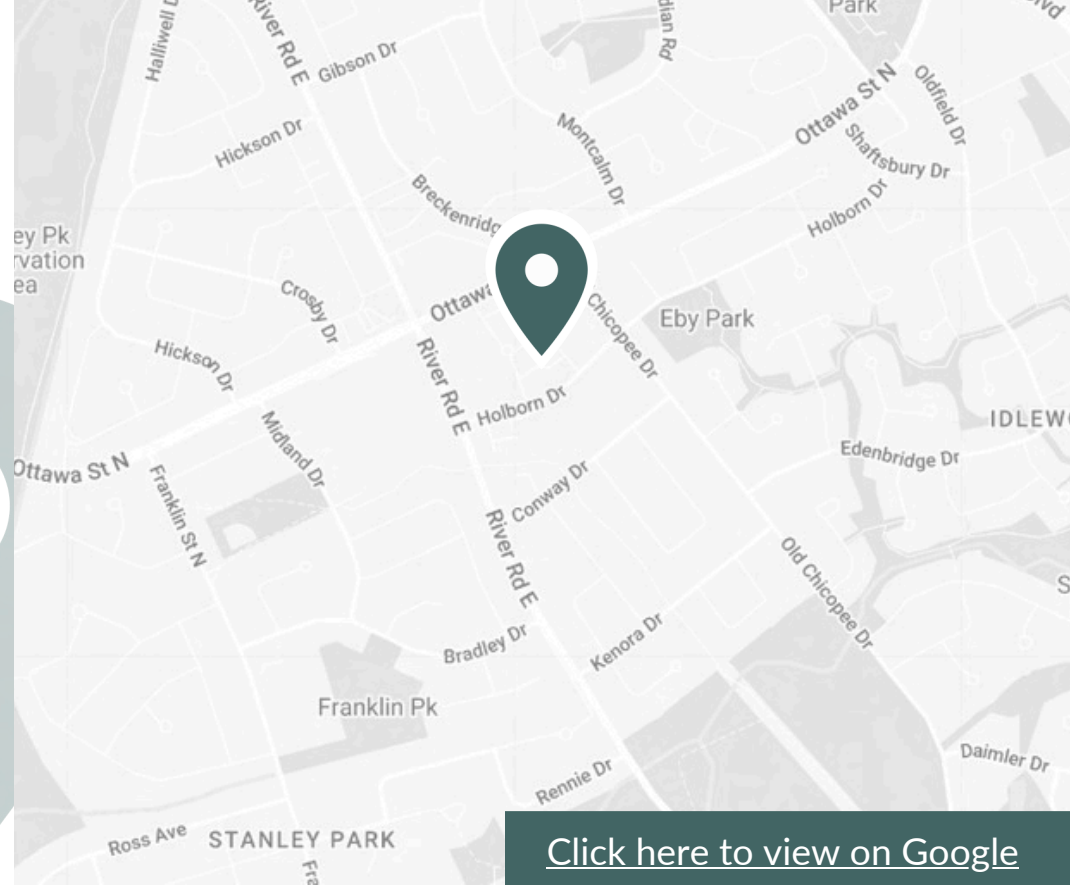

# Neighborhood Features



2-MINUTE DRIVE TO STANLEY  
PARK COMMUNITY CENTRE (600M)



3-MINUTE DRIVE TO FRANKLIN  
PUBLIC SCHOOL (1.4KM)



5-MINUTE DRIVE TO GRAND  
RIVER ARENA (1.8KM)



Nearest Bus line  
River / Stanley Park Mall (on site)



Nearest Rail line  
Kitchener GO (5.4km)



Population (5km)  
131,804



Household Income (5km)  
\$90,111



Households (5km)  
56,743



Bike Score  
72



Walk Score  
78



Traffic count  
25,600

## Near by amenities and tenants





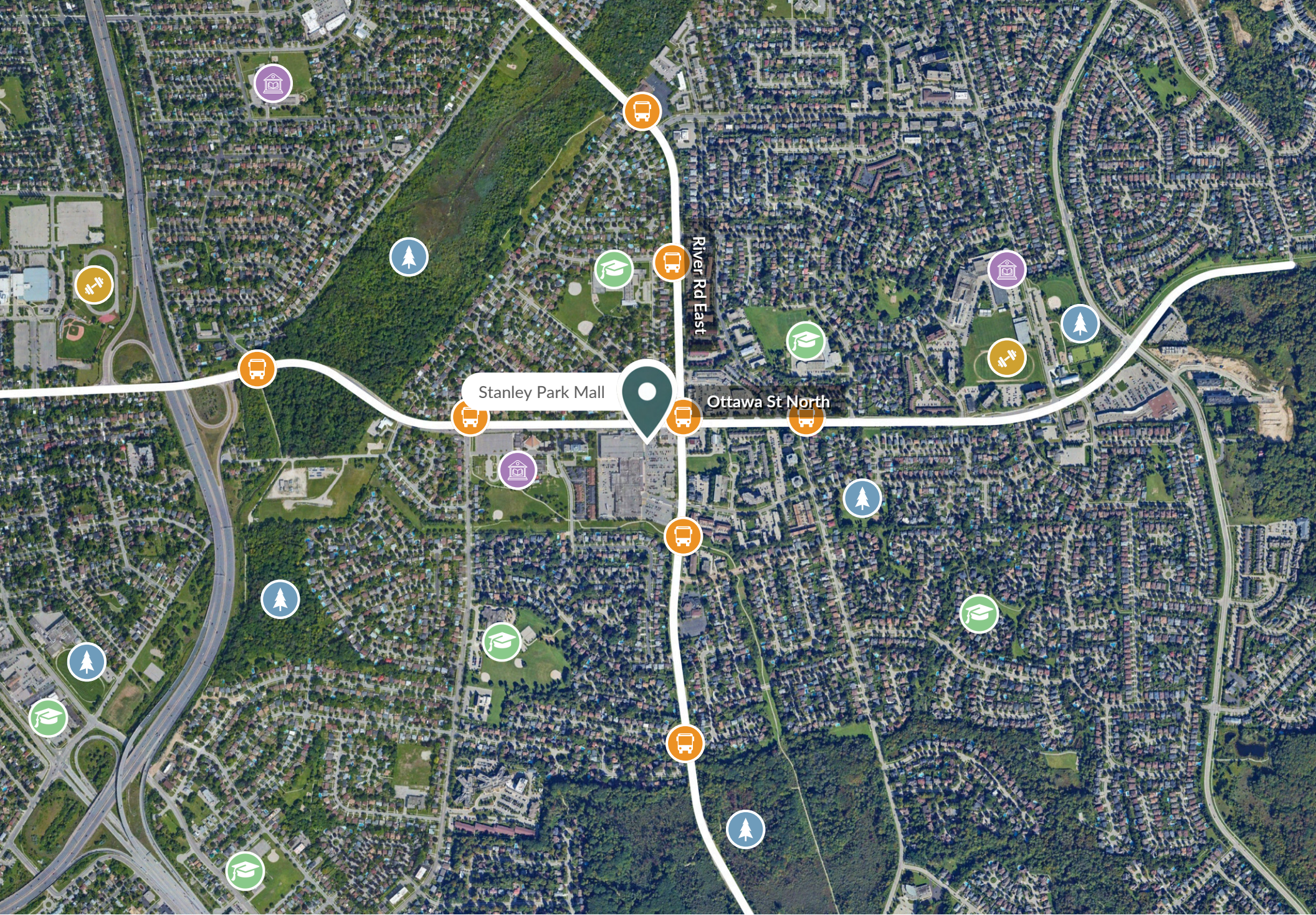

Stanley Park Mall

River Rd East

Ottawa St North

 Community Centre

 Fitness and Wellness

 Parks

 Schools

 Transit Stops



# Site Plan



Unit	SF	Availability
A	1,119	Immediately
B	3,831	2025 Q4



# Unit A

Unit A01026B - 1,119 sf





# Unit A01026B

Size	1,119 sf
Unit Number	A01026B
Available	Immediately
Ideal Use	Fitness, Medical, Personal services, General Retail

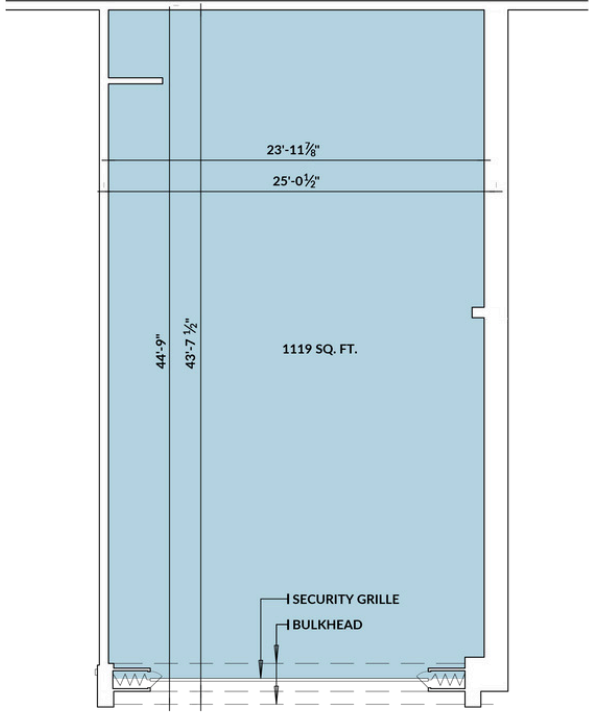



# Unit B

Unit A01003A - 3,831 sf





# Unit A01003A

Size	3,831 sf
Unit Number	A01003A
Available	2025 Q4
Ideal Use	Fitness, Medical, Personal services, General Retail

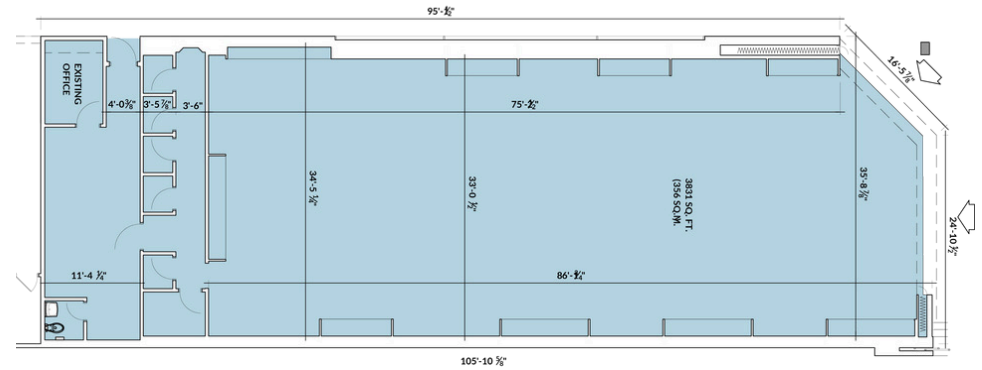

\*2025 Estimates





Andrew Chiaino  
Leasing Representative  
[andrew.chiaino@fcr.ca](mailto:andrew.chiaino@fcr.ca)  
647.501.7635