

The Molson Building is located on 1st Avenue NE, a high-traffic corridor just minutes from Downtown Calgary and the Bow River.

With strong transit access and excellent visibility, it offers great connectivity to the city and surrounding neighbourhoods.



Availability: 11,027 sf

Property Manager
Melissa Grassi
melissa.grassi@fcr.ca

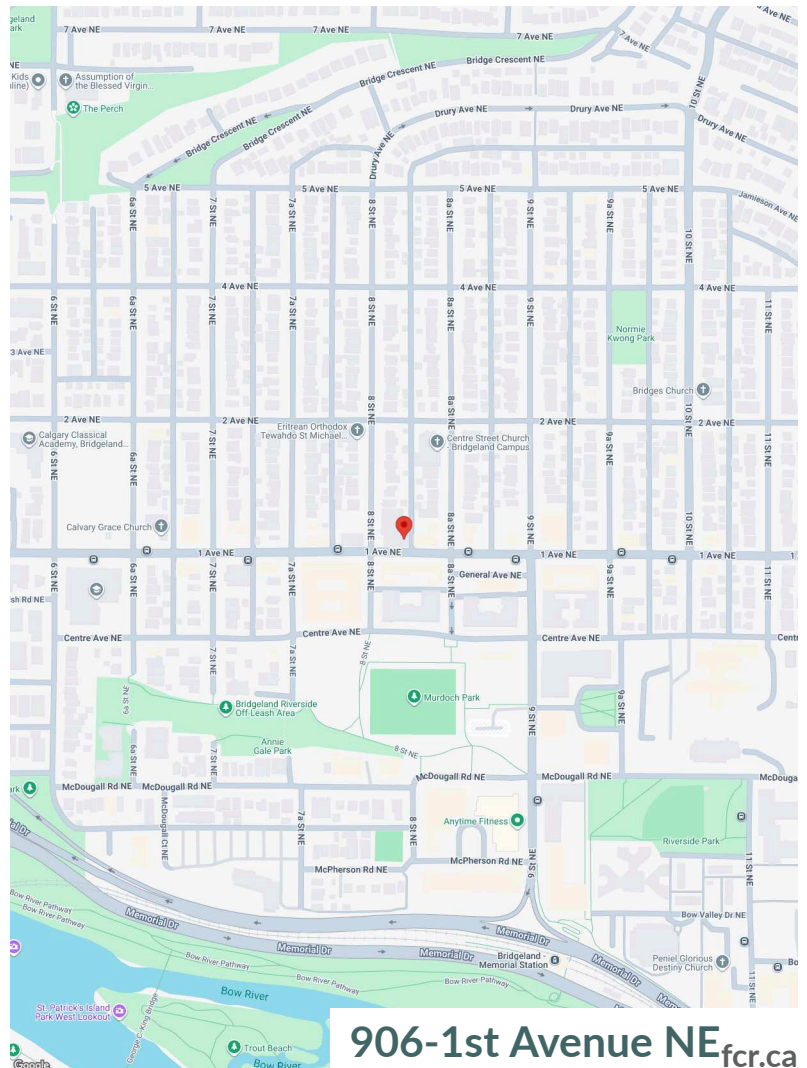
FCR Leasing
fcr.ca
leasing@fcr.ca
403.257.6888



906-1st Avenue NE fcr.ca

		1km	3km	5km
	Household Income	\$120,352	\$143,274	\$161,673
	Households	10,023	54,775	108,372
	Population	22,062	110,009	228,834



Walk Score 87



Transit Score 63

Siteplan

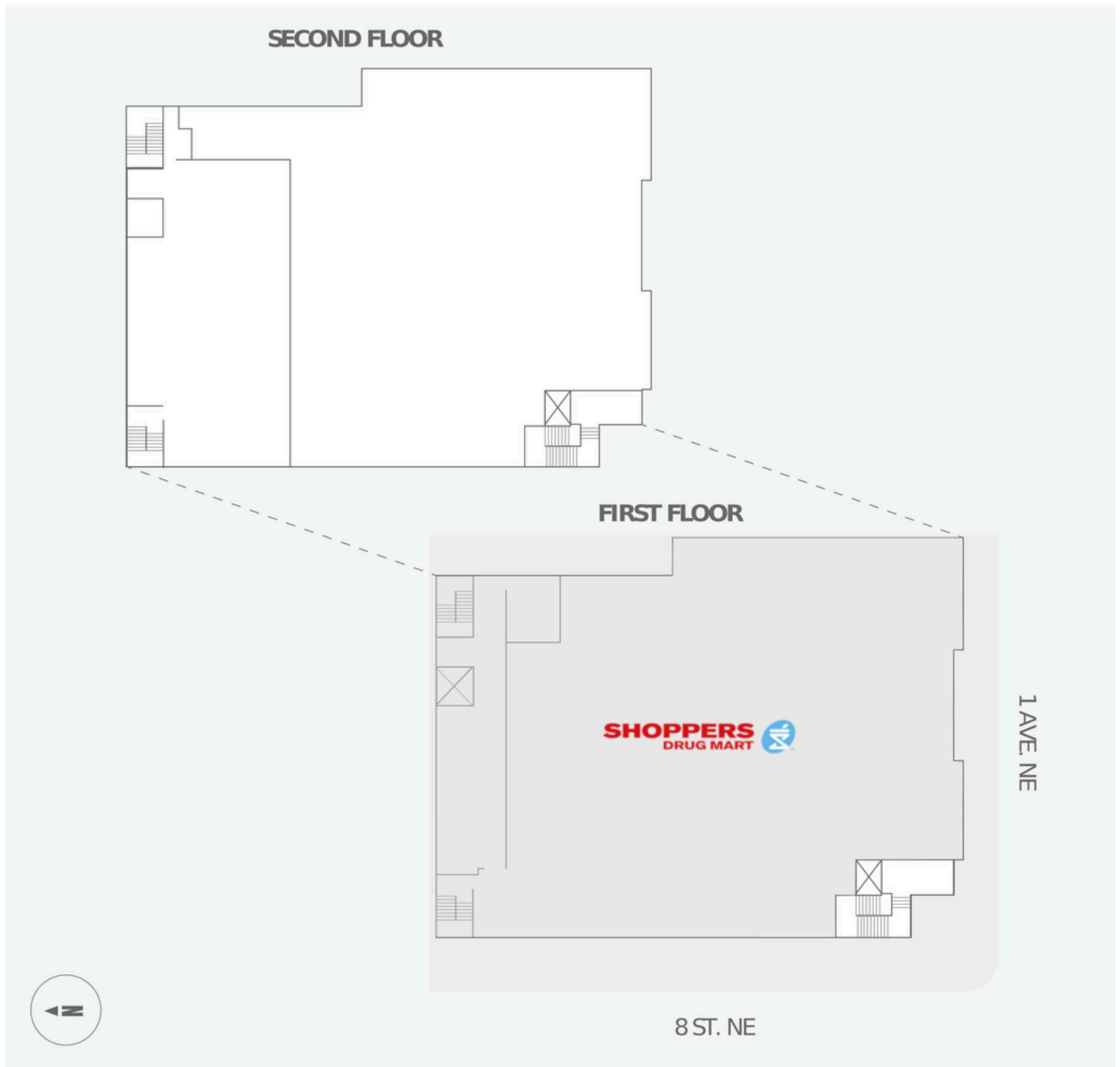

Current Tenants

Shoppers Drug Mart



Current Availability

11,027 sf 22110-A02001A

Contact



Melissa Grassi
Property Manager
melissa.grassi@fcr.ca

