

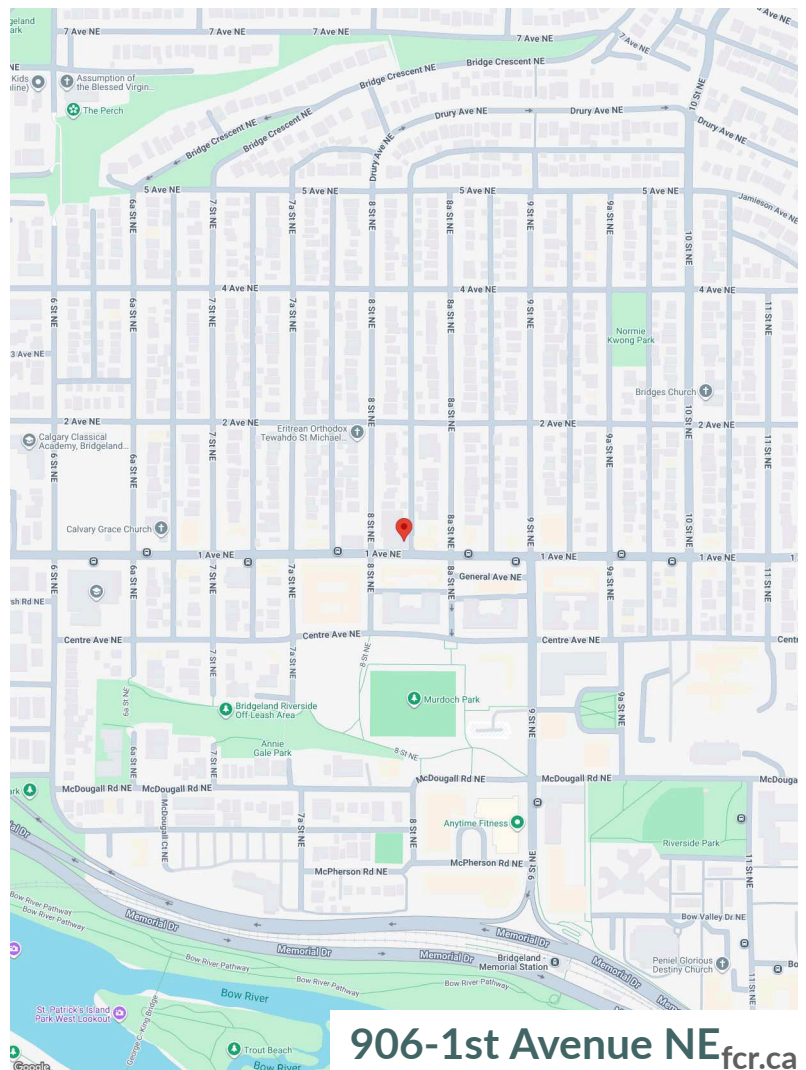



The Molson Building is located on 1st Avenue NE, a high-traffic corridor just minutes from Downtown Calgary and the Bow River.

With strong transit access and excellent visibility, it offers great connectivity to the city and surrounding neighbourhoods.

**Property Manager**  
Melissa Grassi  
melissa.grassi@fcr.ca

**FCR Leasing**  
fcr.ca  
leasing@fcr.ca  
403.257.6888



		1km	3km	5km
	Household Income	\$114,547	\$139,957	\$154,146
	Households	9,097	53,385	107,062
	Population	18,840	99,844	211,262



Walk Score 87



Transit Score 63

**Siteplan**

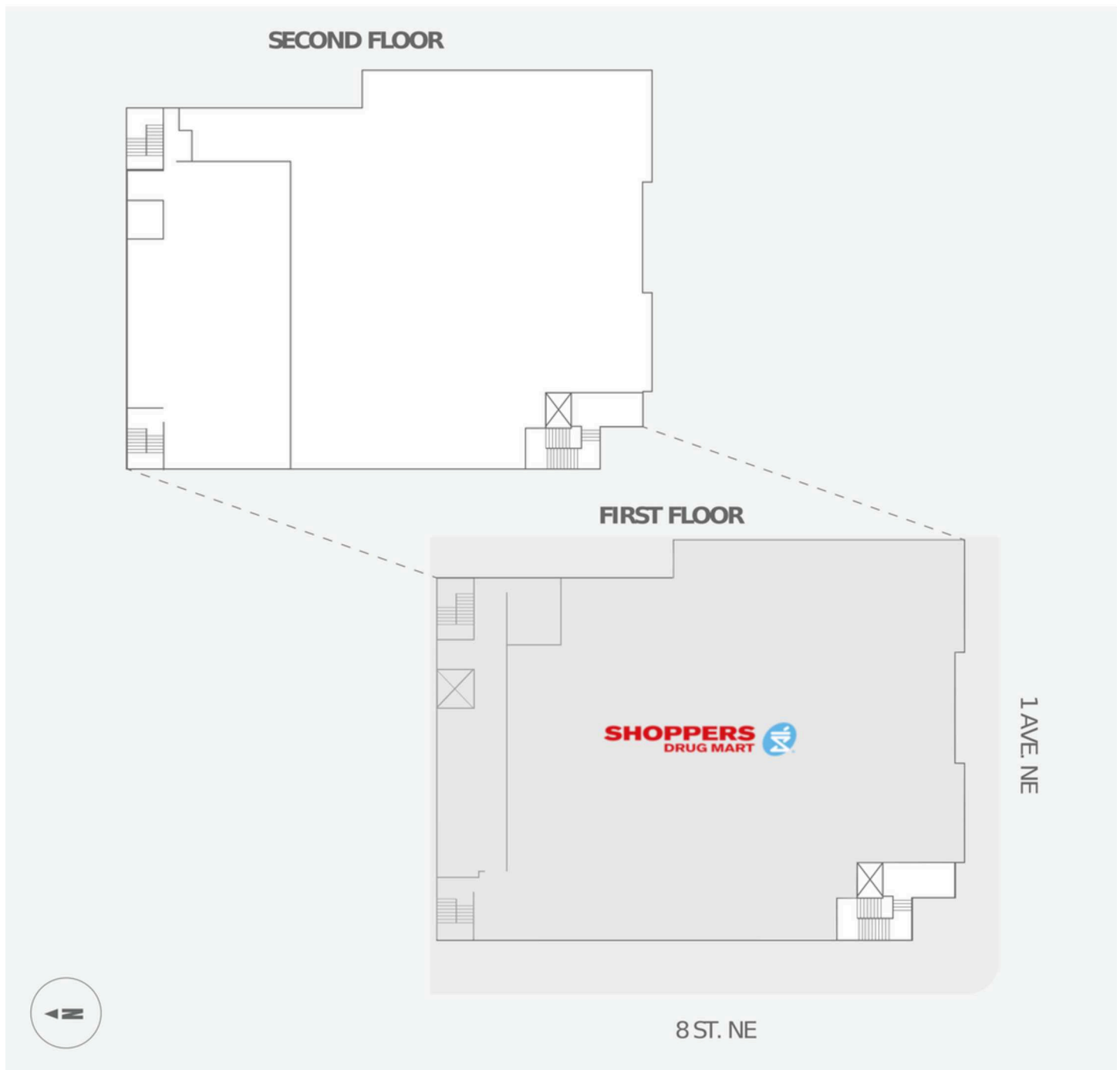

## Current Tenants

Shoppers Drug Mart



## Contact



Melissa Grassi  
Property Manager  
[melissa.grassi@fcr.ca](mailto:melissa.grassi@fcr.ca)

