

THE BREWERY DISTRICT



The Brewery District
Edmonton, AB

Senior Leasing Manager
Judee Orfino
judee.orfino@fcr.ca
780-224-4790

FCR Leasing
fcr.ca
leasing@fcr.ca
403.257.6888



The Brewery District

Edmonton, AB

sf: 284,238

Located at 104th Avenue and 121 Street, just minutes from the downtown core is the Edmonton Brewery District. This development offers an architectural design that is both historical and current in its approach.

With close proximity to MacEwan University and Edmonton's new Ice District, the Edmonton Brewery District will also be within a block of a future LRT line. This mixed-use property is anchored by a 40,000 sf GoodLife Fitness, 40,000 sf MEC, 23,000 sf DSW, 22,000 sf Winners, 13,000 sf Shoppers Drug Mart, and 40,000 sf Loblaws City Market – the first of its kind in Edmonton.

The Edmonton Brewery District accommodates an urban lifestyle with its unique blend of products and services – all conveniently located within a short distance. Surrounding the Edmonton Brewery District is a diverse population consisting of students, young professionals, empty nesters and seniors. To accommodate the growing population in the area, the Edmonton Brewery District offers a heated and secure 6-acre underground parkade, free for customers' use.

Availability: 1,231 - 2,277 sf

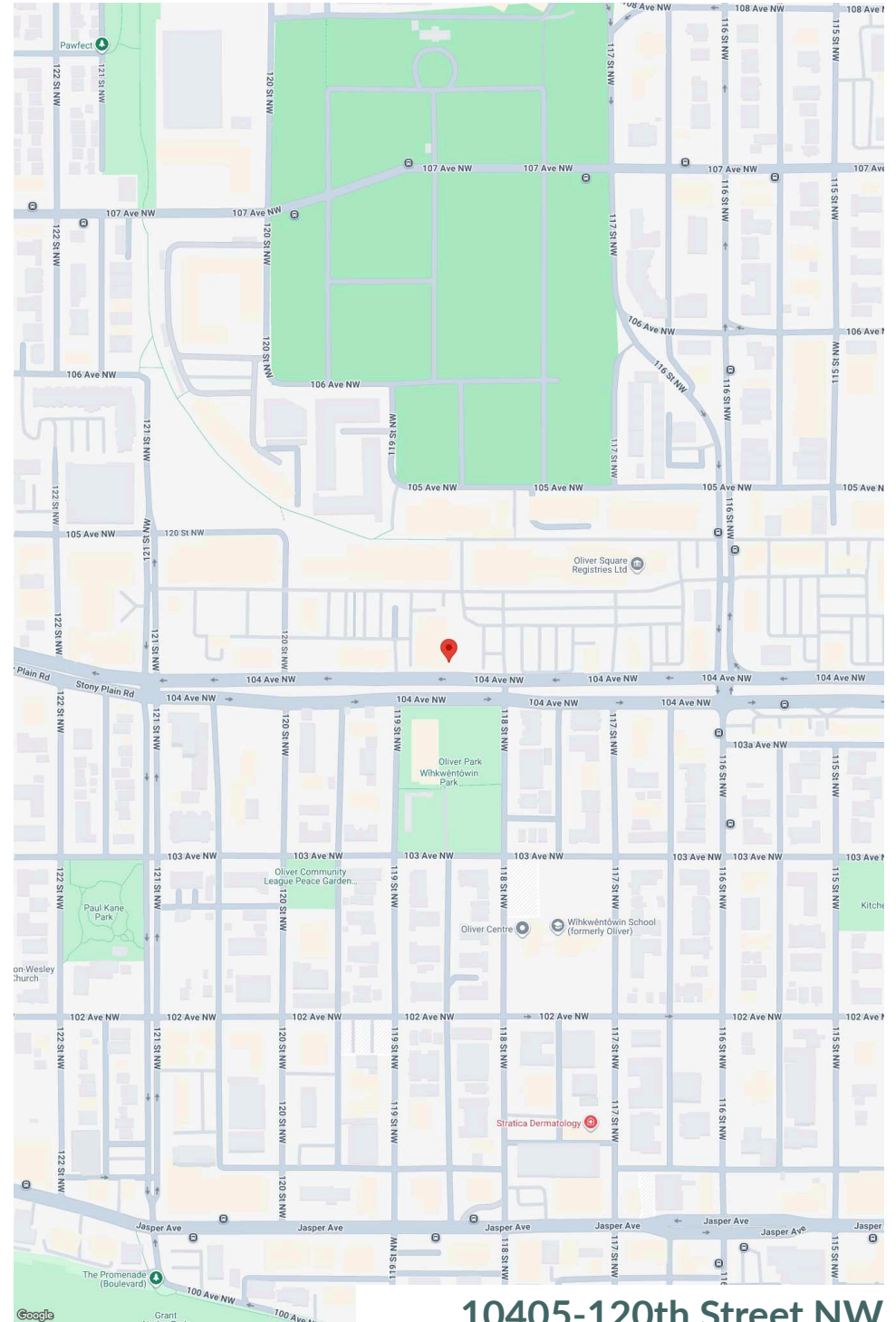

10405-120th Street NW

The Brewery District

Demographics



Traffic Count

118th St NW / 104th Ave NW : 21,900



Walk Score

75



Transit Score

60



Household Income

1km

\$81,083

3km

\$91,617

5km

\$97,672



Households

13,489

49,522

104,867



Population

23,232

96,572

220,537

Site plan



Second Floor

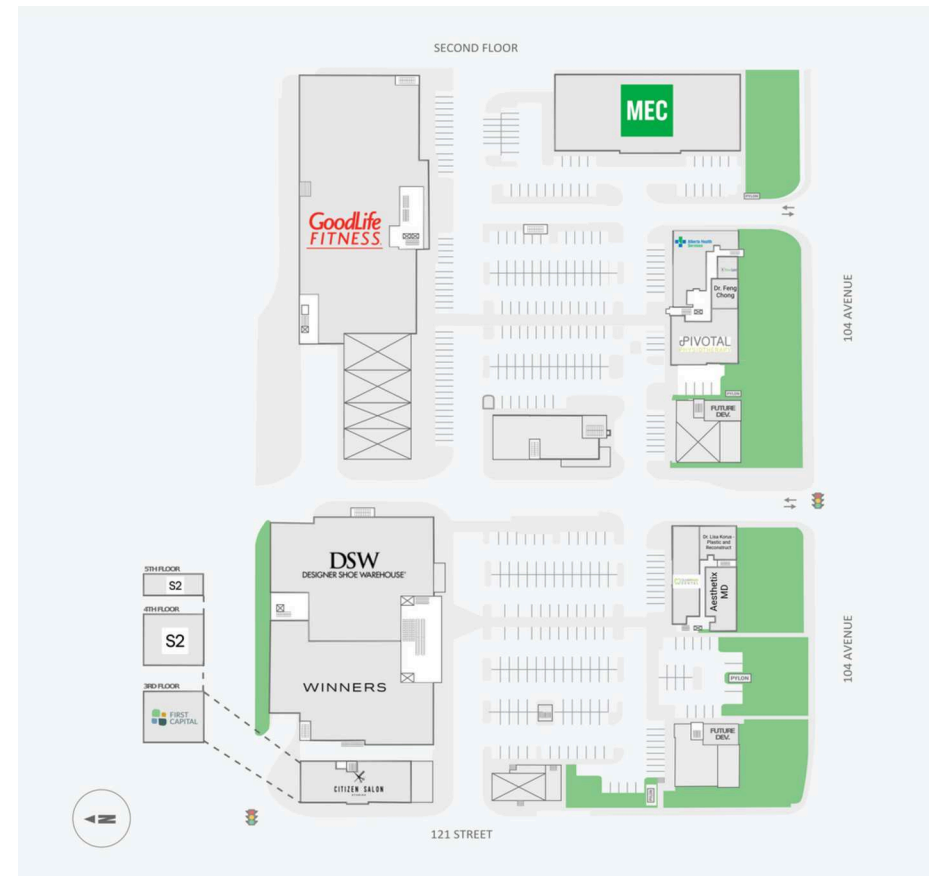

Current Tenants

Nero Restaurant
S2 Architecture
Citizen Salon Studios
First Capital REIT
Loblaws
DSW - Designer Shoe
Warehouse
Winners
South St. Burger Co
Wing Snob
FYiDoctors
Doughnut Party
Tokiwa Ramen
Supplement King
Massage Heights
Fjallraven
The Alley
Shoppers Drug Mart
Dollarama
PETLAND
GoodLife Fitness
MEC Canada Inc.
Nando's
Booster Juice

Unavailable
Tommy Gun's Original
Barbershop
Rogers
Rosie's Burgers
Starbucks
Pivotal Physiotherapy
Dr. Feng Chong
Divine Spine
Alberta Health Services
Evoolution
Cobs Bread
Anejo Restaurant
TD Canada Trust
Blaze Fast Fire'd Pizza
Aesthetix MD
Oliver Park Dental
Dr. Lisa Korus - Plastic
and Reconstruct
Wilfred's
Wilfred's & Made by
Marcus
Kin

fcr.ca

Current Availability

2,277 sf 30120-C01011A
1,231 sf 30120-E01005A

Contact



Judee Orfino
Senior Leasing
Manager
judee.orfino@fcr.ca
780-224-4790



WINNERS

