

THE BREWERY DISTRICT



The Brewery District
Edmonton, AB

Senior Director, Leasing
Ben Jasper
ben.jasper@fcr.ca
780.377.2529

FCR Leasing
fcr.ca
leasing@fcr.ca
403.257.6888



The Brewery District

Edmonton, AB

sf: 284,238

Located at 104th Avenue and 121 Street, just minutes from the downtown core is the Edmonton Brewery District. This development offers an architectural design that is both historical and current in its approach.

With close proximity to MacEwan University and Edmonton's new Ice District, the Edmonton Brewery District will also be within a block of a future LRT line. This mixed-use property is anchored by a 40,000 sf GoodLife Fitness, 40,000 sf MEC, 23,000 sf DSW, 22,000 sf Winners, 13,000 sf Shoppers Drug Mart, and 40,000 sf Loblaw's City Market – the first of its kind in Edmonton.

The Edmonton Brewery District accommodates an urban lifestyle with its unique blend of products and services – all conveniently located within a short distance. Surrounding the Edmonton Brewery District is a diverse population consisting of students, young professionals, empty nesters and seniors. To accommodate the growing population in the area, the Edmonton Brewery District offers a heated and secure 6-acre underground parkade, free for customers' use.

Availability: 1,004 - 1,004 sf

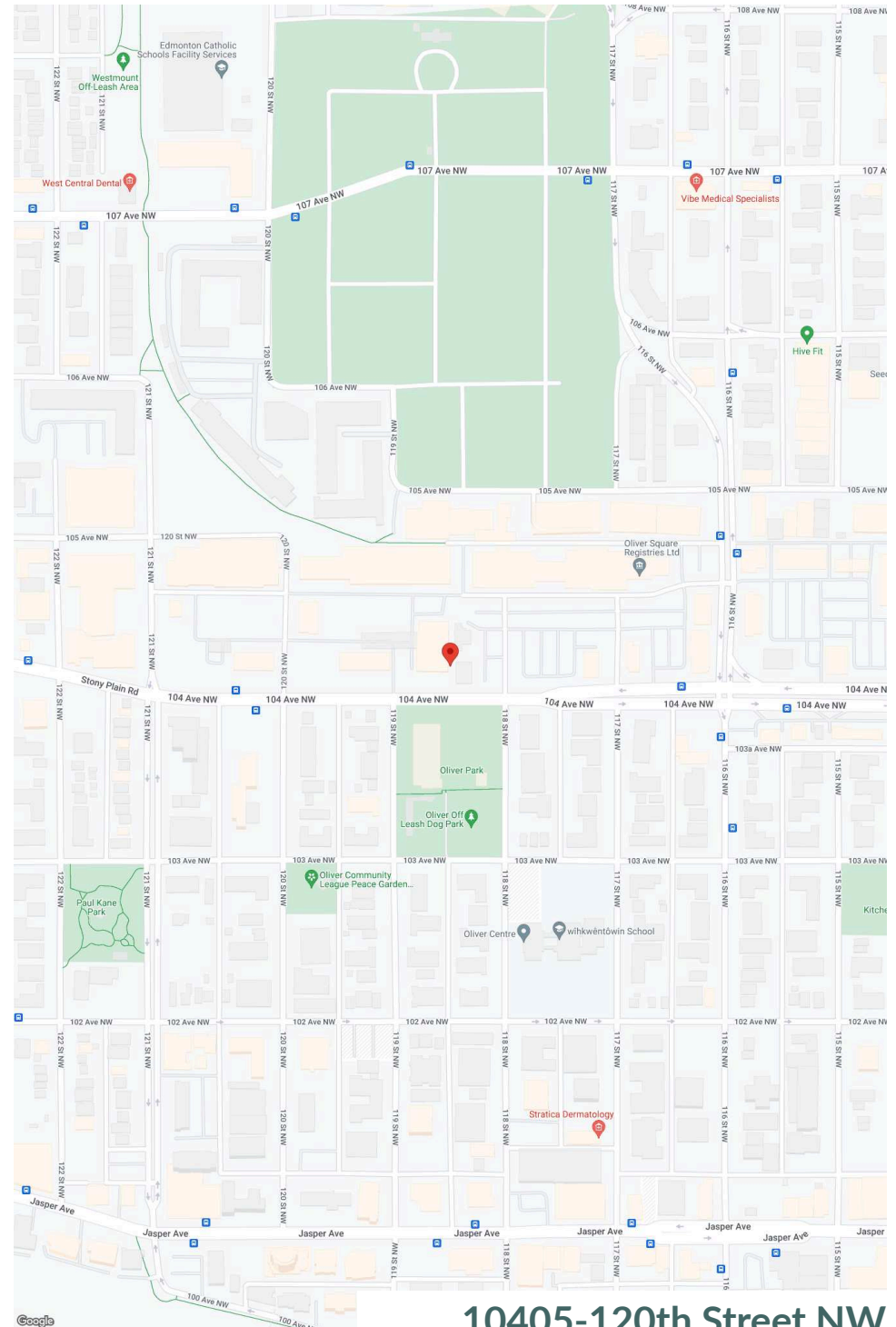

10405-120th Street NW

The Brewery District

Demographics



Traffic Count

118th St NW / 104th Ave NW : 21,900



Walk Score



75



Transit Score

60



| | 1km | 3km | 5km |
|--|----------|----------|----------|
| <div></div> <div>Household Income</div> | \$91,800 | \$95,959 | \$96,353 |
| <div></div> <div>Households</div> | 12,698 | 45,484 | 98,913 |
| <div></div> <div>Population</div> | 21,143 | 90,617 | 211,421 |

Site plan

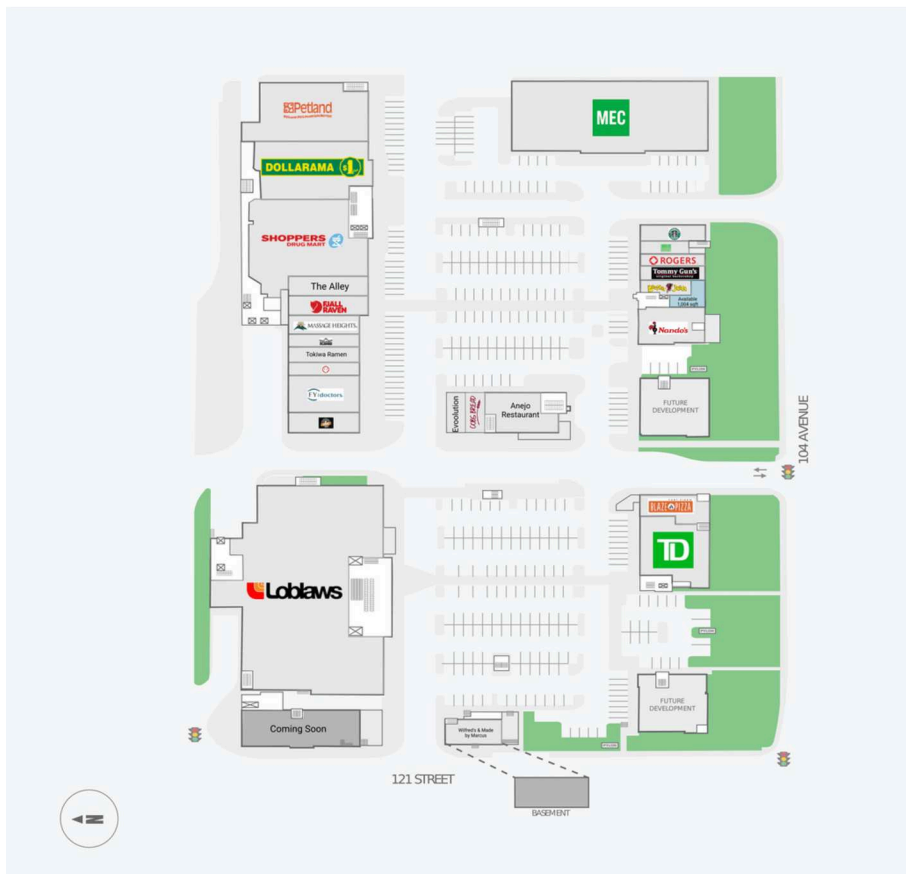

Second Floor

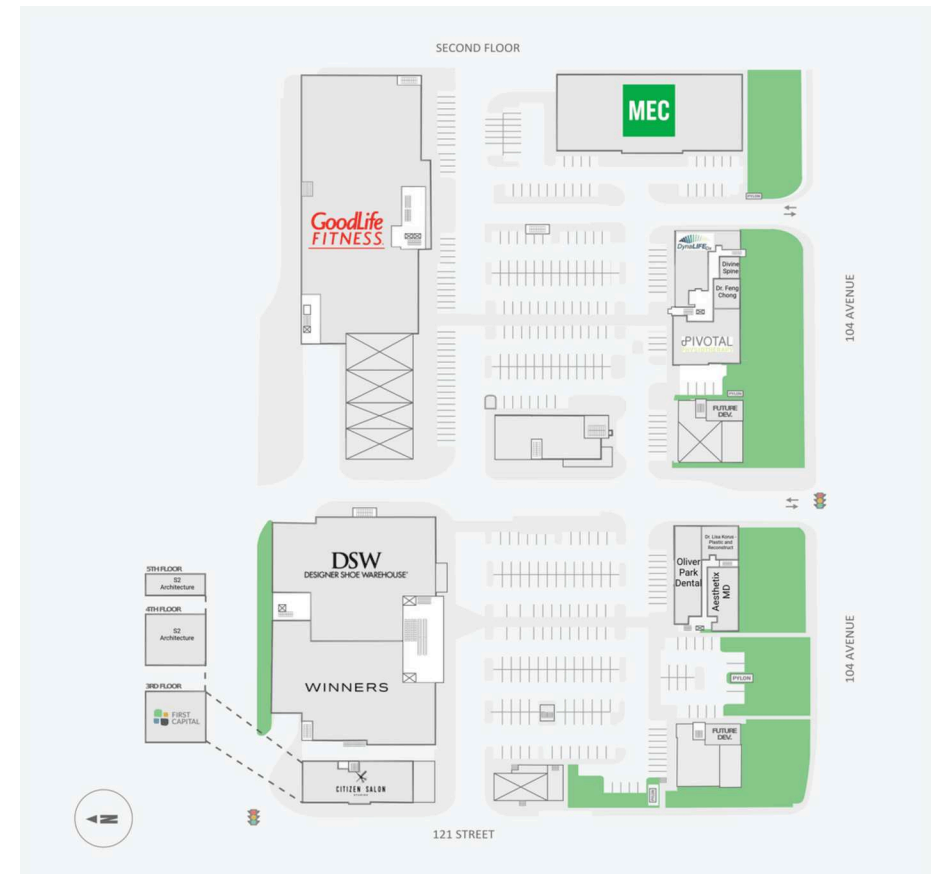

Current Tenants

Nero Restaurant
S2 Architecture
Citizen Salon Studios
First Capital REIT
Loblaws
DSW - Designer Shoe Warehouse
Winners
South St. Burger Co
Wing Snob
FYiDoctors
Doughnut Party
Tokiwa Ramen
Supplement King
Massage Heights
Fjallraven
The Alley
Shoppers Drug Mart
Dollarama
PETLAND
GoodLife Fitness
MEC Canada Inc.
Nando's
Booster Juice

Tommy Gun's Original Barbershop
Rogers
Freshii
Starbucks
Pivotal Physiotherapy
Dr. Feng Chong
Divine Spine
Dynalife Dx
Evolution
Cobs Bread
Anejo Restaurant
TD Canada Trust
Blaze Fast Fire'd Pizza
Aesthetix MD
Oliver Park Dental
Dr. Lisa Korus - Plastic and Reconstruct
Wilfred's
Wilfred's & Made by Marcus
Moon Rabbit Cocktail Bar

fcr.ca

Current Availability

1,004 sf 30120-E01003B

Contact



Ben Jasper
Senior Director,
Leasing
ben.jasper@fcr.ca
780.377.2529



WINNERS

